

SHREE SHYAM DEVELOPER

Regd. Off : Ramkrishna Nagar, Midnapore, 721101

PAN : AFFFS9291B

Site : Basudha Enclave, Saratpally, Midnapore, 721101

TO WHOM IT MAY CONCERN

Location Plan of proposed project "BASUDHA ENCLAVE" situated at Holding No. 1035 (Full), Mouza – Narampur, J.L. No.- 174, R.S. Plot No.- 34, L.R. Plot No.- 963, Ward No.- 23, Street- Saratpally, P.S.– Midnapore, Dist.– Paschim Medinipur, Pin– 721101; is shown below:

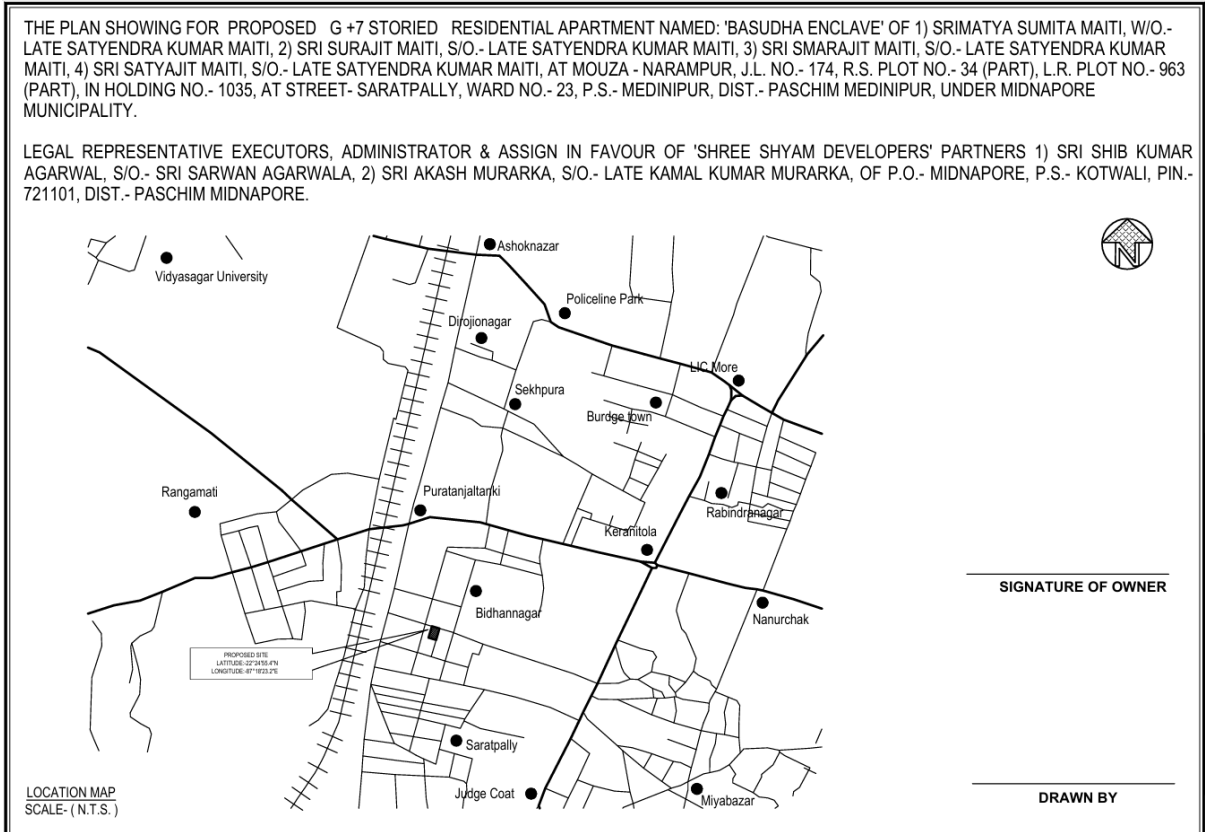

Latitude: 22°24'55.4"N
Longitude: 87°18'23.2"E

For SHREE SHYAM DEVELOPER

SHREE SHYAM DEVELOPER
Mushtak Murarka
PARTNER

SHREE SHYAM DEVELOPER
Shib Kumar Agarwal
PARTNER

Siddhartha Sahoo
Er. Siddhartha Sahoo
B.Tech (Civil Engineer)
LBS, Class - I
Reg. No : MIDR-SS-1/02/23
Midnapore Municipality
Mob. No : 9775576501

E-mail : shibagarwal.wb@gmail.com
Contact Number : 9333380215 / 9434000860